

Multi V Air Conditioner

SVC MANUAL(Exploded View)

MODEL :	ARNU073BHA2	ARNU283BGA2	ARNU073BGA4
	ARNU093BHA2	ARNU363BGA2	ARNU093BGA4
	ARNU123BHA2	ARNU423BGA2	ARNU123BGA4
	ARNU153BHA2	ARNU283BRA2	ARNU153BGA4
	ARNU183BHA2	ARNU363BRA2	ARNU183BGA4
	ARNU243BHA2	ARNU423BRA2	ARNU243BGA4
	ARNU073BGA2	ARNU483BRA2	ARNU283BGA4
	ARNU093BGA2	ARNU543BRA2	ARNU363BGA4
	ARNU123BGA2		ARNU423BGA4
	ARNU153BGA2		ARNU483BRA4
	ARNU183BGA2		ARNU543BRA4
	ARNU243BGA2		

CAUTION

Before Servicing the unit, read the safety precautions in General SVC manual.
Only for authorized service personnel.

1. Specification

Type		Ceiling Concealed Duct -High Static				
Model	Unit	ARNU073BHA2	ARNU093BHA2	ARNU123BHA2	ARNU153BHA2	
Cooling Capacity	kW	2.2	2.8	3.6	4.5	
	kcal/h	1,900	2,400	3,100	3,900	
	Btu/h	7,500	9,600	12,300	15,400	
Heating Capacity	kW	2.5	3.2	4.0	5.0	
	kcal/h	2,200	2,800	3,400	4,300	
	Btu/h	8,500	10,900	13,600	17,100	
Casing		Galvanized Steel Plate	Galvanized Steel Plate	Galvanized Steel Plate	Galvanized Steel Plate	
Dimensions(WxDxH)	Body	mm	882x450x260	882x450x260	882x450x260	
		inch	34.7x17.7x10.2	34.7x17.7x10.2	34.7x17.7x10.2	
Coil	Rows x Columns x FPI	2x10x21	2x10x21	2x10x21	2x10x21	
	Face Area	m ² (ft ²)	0.15(1.63)	0.15(1.63)	0.15(1.63)	
Fan	Type	Sirocco Fan	Sirocco Fan	Sirocco Fan	Sirocco Fan	
	Motor Output x Number	W	118	118	118	
	Running Current	A	0.92	0.92	0.92	
	Air Flow Rate(H/M/L) (High Mode-factory set)	cmm	6.5/5.8/5.4	8.1/6.5/5.8	9.6/8.1/6.5	11.3/9.6/6.5
		cfm	230/205/191	286/230/205	339/286/230	399/339/230
	External Static Pressure	mmAq (in.Aq)	8(0.31)	8(0.31)	8(0.31)	
	Air Flow Rate(H/M/L) (Standard Mode)	cmm	7.3/6.3/5.6	7.3/6.3/5.6	8.7/7.3/5.6	11/10.1/8.7
		cfm	258/222/198	258/222/198	307/258/198	388/357/307
	External Static Pressure	mmAq (in.Aq)	6(0.23)	6(0.23)	6(0.23)	
Drive		Direct	Direct	Direct		
Motor type		BLDC	BLDC	BLDC		
Temperature Control		Microprocessor, Thermostat for cooling and heating	Microprocessor, Thermostat for cooling and heating	Microprocessor, Thermostat for cooling and heating	Microprocessor, Thermostat for cooling and heating	
Sound Absorbing Thermal Insulation Material		Foamed polystyrene	Foamed polystyrene	Foamed polystyrene	Foamed polystyrene	
Air Filter		-	-	-	-	
Safety Device		Fuse	Fuse	Fuse	Fuse	
Pipe Connections	Liquid Side	mm(inch)	Ø6.35(1/4)	Ø6.35(1/4)	Ø6.35(1/4)	
	Gas Side	mm(inch)	Ø12.7(1/2)	Ø12.7(1/2)	Ø12.7(1/2)	
	Drain Pipe(Internal Dia.)	mm(inch)	25.0(1)	25.0(1)	25.0(1)	
Net Weight	Body	kg(lbs)	26(57.4)	26(57.4)	26(57.4)	
Noise Level(Sound Press, 1.5m(4.9ft) H/M/L)		dB(A)±1	35/34/33	35/34/33	37/35/34	
Power Supply		Ø, V, Hz	1,208/230,60	1,208/230,60	1,208/230,60	
Refrigerant Control			EEV	EEV	EEV	
Power cable		mm ²	CV1.5 x 3C	CV1.5 x 3C	CV1.5 x 3C	
Transmission Cable (AWG#-C)		mm ²	CVV-SB 1.25x2C (12-2)	CVV-SB 1.25x2C (12-2)	CVV-SB 1.25x2C (12-2)	

Notes:-

1. Capacities are based on the following conditions:

- Cooling
 - Indoor temp. 27°C[80.6°F]DB/ 19°C[66.2°F]WB
 - Outdoor temp. 35°C[95°F]DB/ 24°C[75.2°F]WB
 - Interconnecting Piping Length 7.5m(24.6ft)
 - Level Difference of Zero
- Heating
 - Indoor temp. 20°C[68°F]DB/ 15°C[59°F]WB
 - Outdoor temp. 7°C[44.6°F]DB/ 6°C[42.8°F]WB
 - Interconnecting Piping Length 7.5m(24.6ft)
 - Level Difference of Zero

2. Capacities are net capacities

3. Due to our policy of innovation some specifications may be changed without prior notification

4. To be added for more available Models

5. EEV : Electronic Expansion Valve

6. Noise Level is Standard Mode

(for actual High Mode(factory set) condition, Noise Level may exceed the standard level by 1.5dBA)

Conversion Formula

kcal/h= kW x 860
 Btu/h = kW x 3412
 cfm = m³/min x 35.3
 l/s = CMM x 1000/60

Type			Ceiling Concealed Duct(High Static)		
Model		Unit	ARNU183BHA2	ARNU243BHA2	ARNU073BGA2
Cooling Capacity		kW	5.6	7.1	2.2
		kcal/h	4,800	6,100	1,900
		Btu/h	19,100	24,200	7,500
Heating Capacity		kW	6.3	8	2.5
		kcal/h	5,400	6,900	2,200
		Btu/h	21,500	27,300	8,500
Casing			Galvanized Steel Plate	Galvanized Steel Plate	Galvanized Steel Plate
Dimensions(WxDxH)	Body	mm	882x450x260	882x450x260	1,182x298x450
		inch	34.7x17.7x10.2	34.7x17.7x10.2	46.5 x10.2x17.7
Coil	Rows x Columns x FPI		3x10x21	3x10x21	3x12x21
	Face Area	m ² (ft ²)	0.15(1.63)	0.15(1.63)	0.26(2.82)
Fan	Type		Sirocco Fan	Sirocco Fan	Sirocco Fan
	Motor Output x Number	W	118	118	350
	Running Current	A	0.92	0.92	2.65
	Air Flow Rate(H/M/L) (High Mode-factory set)	cmm	13/11.3/9.6	16/14.4/13	12.5/11.5/9.4
		cfm	459/399/339	565/509/459	441/406/332
	External Static Pressure	mmAq (in.Aq)	8(0.31)	8(0.31)	6(0.23)
	Air Flow Rate(H/M/L) (Standard Mode)	cmm	13.2/11.7/7.3	17.5/14.7/12.6	14.6/13.7/12.3
		cfm	466/413/258	618/519/445	516/484/434
	External Static Pressure	mmAq (in.Aq)	6(0.23)	6(0.23)	4(0.15)
Drive		Direct	Direct	Direct	
Motor type		BLDC	BLDC	BLDC	
Temperature Control			Microprocessor, Thermostat for cooling and heating	Microprocessor, Thermostat for cooling and heating	Microprocessor, Thermostat for cooling and heating
Sound Absorbing Thermal Insulation Material			Foamed polystyrene	Foamed polystyrene	Foamed polystyrene
Air Filter			-	-	-
Safety Device			Fuse	Fuse	Fuse
Pipe Connections	Liquid Side	mm(inch)	Ø6.35(1/4)	Ø9.52(3/8)	Ø9.52(3/8)
	Gas Side	mm(inch)	Ø12.7(1/2)	Ø15.88(5/8)	Ø15.88(5/8)
	Drain Pipe(Internal Dia.)	mm(inch)	25.0(1)	25.0(1)	25(1)
Net Weight	Body	kg(lbs)	26.5(58.4)	26.5(58.4)	38(83.8)
Noise Level(Sound Press, 1.5m(4.9ft) H/M/L)		dB(A)±1	42.5/41/37	45/43/41	32/31/30.5
Power Supply		Ø, V, Hz	1,208/230,60	1,208/230,60	1, 208/230, 60
Refrigerant Control			EEV	EEV	EEV
Power cable		mm ²	CV1.5 x 3C	CV1.5 x 3C	CV1.5 x 3C
Transmission Cable (AWG#-C)		mm ²	CVV-SB 1.25x2C (12-2)	CVV-SB 1.25x2C (12-2)	CVV-SB 1.0~1.5 x 2C (12-2)

Notes:-

1. Capacities are based on the following conditions:

- Cooling
 - Indoor temp. 27°C[80.6°F]DB/ 19°C[66.2°F]WB
 - Outdoor temp. 35°C[95°F]DB/ 24°C[75.2°F]WB
 - Interconnecting Piping Length 7.5m(24.6ft)
 - Level Difference of Zero
- Heating
 - Indoor temp. 20°C[68°F]DB/ 15°C[59°F]WB
 - Outdoor temp. 7°C[44.6°F]DB/ 6°C[42.8°F]WB
 - Interconnecting Piping Length 7.5m(24.6ft)
 - Level Difference of Zero

2. Capacities are net capacities

3. Due to our policy of innovation some specifications may be changed without prior notification

4. To be added for more available Models

5. EEV : Electronic Expansion Valve

6. Noise Level is Standard Mode

(for actual High Mode(factory set) condition, Noise Level may exceed the standard level by 1.5dBA)

Conversion Formula

kcal/h= kW x 860
 Btu/h = kW x 3412
 cfm = m³/min x 35.3
 l/s = CMM x 1000/60

Type			Ceiling Concealed Duct(High Static)		
Model		Unit	ARNU093BGA2	ARNU123BGA2	ARNU153BGA2
Cooling Capacity		kW	2.8	3.6	4.5
		kcal/h	2,400	3,100	3900
		Btu/h	9,600	12,300	15400
Heating Capacity		kW	3.2	4	5
		kcal/h	2,800	3,400	4300
		Btu/h	10,900	13,600	17100
Casing			Galvanized Steel Plate	Galvanized Steel Plate	Galvanized Steel Plate
Dimensions(WxDxH)	Body	mm	1,182x298x450	1,182x298x450	1,182x450x298
		inch	46.5 x10.2x17.7	46.5 x10.2x17.7	46.5x17.7x10.2
Coil	Rows x Columns x FPI		3x12x21	3x12x21	3x12x21
	Face Area	m ² (ft ²)	0.26(2.82)	0.26(2.82)	0.26
Fan	Type		Sirocco Fan	Sirocco Fan	Sirocco Fan
	Motor Output x Number	W	350	350	350
	Running Current	A	2.65	2.65	2.65
	Air Flow Rate(H/M/L) (High Mode-factory set)	cmm	12.8/11.5/9.4	13.5/12.1/9.4	13.8/11.8/8.3
		cfm	452/406/332	477/427/332	487/417/293
	External Static Pressure	mmAq (in.Aq)	6(0.23)	6(0.23)	8(80)
	Air Flow Rate(H/M/L) (Standard Mode)	cmm	15.1/13.7/12.3	16.6/15.1/13.7	13.5/12.1/9.0
		cfm	533/484/434	586/533/484	477/427/318
	External Static Pressure	mmAq (in.Aq)	4(0.15)	4(0.15)	6(60)
Drive		Direct	Direct	Direct	
Motor type		BLDC	BLDC	BLDC	
Temperature Control			Microprocessor, Thermostat for cooling and heating	Microprocessor, Thermostat for cooling and heating	Microprocessor, Thermostat for cooling and heating
Sound Absorbing Thermal Insulation Material			Foamed polystrene	Foamed polystrene	Foamed polystrene
Air Filter			-	-	-
Safety Device			Fuse	Fuse	Fuse
Pipe Connections	Liquid Side	mm(inch)	Ø9.52(3/8)	Ø9.52(3/8)	Ø9.52(3/8)
	Gas Side	mm(inch)	Ø15.88(5/8)	Ø15.88(5/8)	Ø15.88(5/8)
	Drain Pipe(Internal Dia.)	mm(inch)	25(1)	25(1)	25
Net Weight	Body	kg(lbs)	38(83.8)	38(83.8)	38(83.8)
Noise Level(Sound Press, 1.5m(4.9ft) H/M/L)		dB(A)±1	32.2/31.4/30.7	32.4/31.8/30.9	37/36/33
Power Supply		Ø, V, Hz	1, 208/230, 60	1, 208/230, 60	1, 220 ~ 240, 50
Refrigerant Control			EEV	EEV	EEV
Power cable		mm ²	CV1.5 x 3C	CV1.5 x 3C	CV1.5 x 3C
Transmission Cable (AWG#-C)		mm ²	CVV-SB 1.0~1.5 x 2C (12-2)	CVV-SB 1.0~1.5 x 2C (12-2)	CVV-SB 1.0~1.5 x 2C(12-2)

Notes:-

1. Capacities are based on the following conditions:

- Cooling
 - Indoor temp. 27°C[80.6°F]DB/ 19°C[66.2°F]WB
 - Outdoor temp. 35°C[95°F]DB/ 24°C[75.2°F]WB
 - Interconnecting Piping Length 7.5m(24.6ft)
 - Level Difference of Zero
- Heating
 - Indoor temp. 20°C[68°F]DB/ 15°C[59°F]WB
 - Outdoor temp. 7°C[44.6°F]DB/ 6°C[42.8°F]WB
 - Interconnecting Piping Length 7.5m(24.6ft)
 - Level Difference of Zero

2. Capacities are net capacities

3. Due to our policy of innovation some specifications may be changed without prior notification

4. To be added for more available Models

5. EEV : Electronic Expansion Valve

6. Noise Level is Standard Mode

(for actual High Mode(factory set) condition, Noise Level may exceed the standard level by 1.5dBA)

Conversion Formula

kcal/h= kW x 860
 Btu/h = kW x 3412
 cfm = m³/min x 35.3
 l/s = CMM x 1000/60

Type			Ceiling Concealed Duct(High Static)		
Model		Unit	ARNU183BGA2	ARNU243BGA2	ARNU283BGA2
Cooling Capacity		kW	5.6	7.1	8.2
		kcal/h	4,800	6,100	7,100
		Btu/h	19,100	24,200	28,000
Heating Capacity		kW	6.3	8	9.2
		kcal/h	5,400	6,900	8,000
		Btu/h	21,500	27,300	31,500
Casing			Galvanized Steel Plate	Galvanized Steel Plate	Galvanized Steel Plate
Dimensions(WxDxH)	Body	mm	1,182 x 298 x 450	1,182 x 298 x 450	1,182x450x298
		inch	46-17/32 x 11-23/32 x 17-23/32	46-17/32 x 11-23/32 x 17-23/32	46.5x17.7x10.2
Coil	Rows x Columns x FPI		3 x 12 x 21	3 x 12 x 21	3x12x21
	Face Area	m ² (ft ²)	0.26(2.82)	0.26(2.82)	0.26(2.82)
Fan	Type		Sirocco Fan	Sirocco Fan	Sirocco Fan
	Motor Output x Number	W	350	350	350
	Running Current	A	2.65	2.65	2.65
	Air Flow Rate(H/M/L) (High Mode-factory set)	cmm	15.2 / 13.8 / 11.8	19.0 / 15.2 / 13.8	25.9/24.1/21.8
		cfm	537 / 487 / 417	671 / 537 / 487	915/851/770
	External Static Pressure	mmAq (in.Aq)	8(80)	8(80)	10(0.39)
	Air Flow Rate(H/M/L) (Standard Mode)	cmm	15.5 / 13.3 / 12.1	19.0 / 16.3 / 15.5	25.3/21.8/17.6
		cfm	547 / 470 / 427	671 / 576 / 547	893/770/622
	External Static Pressure	mmAq (in.Aq)	6(60)	6(60)	8(0.31)
Drive		Direct	Direct	Direct	
Motor type		BLDC	BLDC	BLDC	
Temperature Control			Microprocessor, Thermostat for cooling and heating	Microprocessor, Thermostat for cooling and heating	Microprocessor, Thermostat for cooling and heating
Sound Absorbing Thermal Insulation Material			Foamed polystyrene	Foamed polystyrene	Foamed polystyrene
Air Filter			-	-	-
Safety Device			Fuse	Fuse	Fuse
Pipe Connections	Liquid Side	mm(inch)	Ø9.52(3/8)	Ø9.52(3/8)	Ø9.52(3/8)
	Gas Side	mm(inch)	Ø15.88(5/8)	Ø15.88(5/8)	Ø15.88(5/8)
	Drain Pipe(Internal Dia.)	mm(inch)	25(1)	25(1)	25.0(1)
Net Weight	Body	kg(lbs)	38(83.8)	38(83.8)	38(83.8)
Noise Level(Sound Press, 1.5m(4.9ft) H/M/L)		dB(A)±1	41 / 39 / 37	42 / 39 / 37	44/42/40
Power Supply		Ø, V, Hz	1, 208-230, 60	1, 208-230, 60	1,208/230,60
Refrigerant Control			EEV	EEV	EEV
Power cable		mm ²	CV1.5 x 3C	CV1.5 x 3C	CV1.5 x 3C
Transmission Cable (AWG#-C)		mm ²	CVV-SB 1.0-1.5 x 2C(12-2)	CVV-SB 1.0-1.5 x 2C(12-2)	CVV-SB 1.25x2C (12-2)

Notes:-

1. Capacities are based on the following conditions:

- Cooling
 - Indoor temp. 27°C[80.6°F]DB/ 19°C[66.2°F]WB
 - Outdoor temp. 35°C[95°F]DB/ 24°C[75.2°F]WB
 - Interconnecting Piping Length 7.5m(24.6ft)
 - Level Difference of Zero
- Heating
 - Indoor temp. 20°C[68°F]DB/ 15°C[59°F]WB
 - Outdoor temp. 7°C[44.6°F]DB/ 6°C[42.8°F]WB
 - Interconnecting Piping Length 7.5m(24.6ft)
 - Level Difference of Zero

2. Capacities are net capacities

3. Due to our policy of innovation some specifications may be changed without prior notification

4. To be added for more available Models

5. EEV : Electronic Expansion Valve

6. Noise Level is Standard Mode

(for actual High Mode(factory set) condition, Noise Level may exceed the standard level by 1.5dBA)

Conversion Formula
kcal/h= kW x 860
Btu/h = kW x 3412
cfm = m ³ /min x 35.3
l/s = CMM x 1000/60

Type			Ceiling Concealed Duct(High Static)		
Model		Unit	ARNU363BGA2	ARNU423BGA2	ARNU283BRA2
Cooling Capacity		kW	10.6	12.3	8.2
		kcal/h	9,100	10,600	7,100
		Btu/h	36,200	42,000	28,000
Heating Capacity		kW	11.9	13.8	9.2
		kcal/h	10,200	11,000	8,000
		Btu/h	40,600	43,800	31,500
Casing			Galvanized Steel Plate	Galvanized Steel Plate	Galvanized Steel Plate
Dimensions(WxDxH)	Body	mm	1182x450x298	1182x450x298	1,230 x 380 x 590
		inch	46.5x17.7x10.2	46.5x17.7x10.2	48.4x15x23.2
Coil	Rows x Columns x FPI		3x12x21	3x12x21	3x13x19
	Face Area	m ² (ft ²)	0.26	0.26	0.38(4.12)
Fan	Type		Sirocco Fan	Sirocco Fan	Sirocco Fan
	Motor Output x Number	W	350	350	185x2
	Running Current	A	2.65	2.65	2.3
	Air Flow Rate(H/M/L) (High Mode-factory set)	cmm	32.3/29/25.3	34.5/32.3/30.7	36.2/32.1/28.5
		cfm	1141/1024/893	1218/1141/1084	1,278/1,134/1,007
	External Static Pressure	mmAq (in.Aq)	10(100)	10(100)	14(0.55)
	Air Flow Rate(H/M/L) (Standard Mode)	cmm	28.4/25.3/21.8	32/28.4/27.2	32.6/31.3/30.4
		cfm	1003/893/770	1130/1003/961	1,151/1,105/1,074
	External Static Pressure	mmAq (in.Aq)	8(80)	8(80)	10(0.39)
Drive		Direct	Direct	Direct	
Motor type		BLDC	BLDC	BLDC	
Temperature Control			Microprocessor, Thermostat for cooling and heating	Microprocessor, Thermostat for cooling and heating	Microprocessor, Thermostat for cooling and heating
Sound Absorbing Thermal Insulation Material			Foamed polystrene	Foamed polystrene	Foamed polystrene
Air Filter			-	-	-
Safety Device			Fuse	Fuse	Fuse
Pipe Connections	Liquid Side	mm(inch)	Ø9.52(3/8)	Ø9.52(3/8)	Ø9.52(3/8)
	Gas Side	mm(inch)	Ø15.88(5/8)	Ø15.88(5/8)	Ø15.88(5/8)
	Drain Pipe(Internal Dia.)	mm(inch)	25	25	25(1)
Net Weight	Body	kg(lbs)	38(83.8)	38(83.8)	53(116.8)
Noise Level(Sound Press, 1.5m(4.9ft) H/M/L)		dB(A)±1	46/44/42	48/46/45	41/40/39
Power Supply		Ø, V, Hz	1, 220 ~ 240, 50	1, 220 ~ 240, 50	1, 208/230, 60
Refrigerant Control			EEV	EEV	EEV
Power cable		mm ²	CV1.5 x 3C	CV1.5 x 3C	CV1.5 x 3C
Transmission Cable (AWG#-C)		mm ²	1.0 ~ 1.5 x 2C	1.0 ~ 1.5 x 2C	CVV-SB 1.0~1.5 x 2C (12-2)

Notes:-

1. Capacities are based on the following conditions:

- Cooling
 - Indoor temp. 27°C[80.6°F]DB/ 19°C[66.2°F]WB
 - Outdoor temp. 35°C[95°F]DB/ 24°C[75.2°F]WB
 - Interconnecting Piping Length 7.5m(24.6ft)
 - Level Difference of Zero
- Heating
 - Indoor temp. 20°C[68°F]DB/ 15°C[59°F]WB
 - Outdoor temp. 7°C[44.6°F]DB/ 6°C[42.8°F]WB
 - Interconnecting Piping Length 7.5m(24.6ft)
 - Level Difference of Zero

2. Capacities are net capacities

3. Due to our policy of innovation some specifications may be changed without prior notification

4. To be added for more available Models

5. EEV : Electronic Expansion Valve

6. Noise Level is Standard Mode

(for actual High Mode(factory set) condition, Noise Level may exceed the standard level by 1.5dBA)

Conversion Formula

kcal/h= kW x 860
 Btu/h = kW x 3412
 cfm = m³/min x 35.3
 l/s = CMM x 1000/60

Type			Ceiling Concealed Duct(High Static)	
Model		Unit	ARNU363BRA2	ARNU423BRA2
Cooling Capacity		kW	10.6	12.3
		kcal/h	9,100	10,600
		Btu/h	36,200	42,000
Heating Capacity		kW	11.9	13.8
		kcal/h	10,200	11,000
		Btu/h	40,600	43,800
Casing			Galvanized Steel Plate	Galvanized Steel Plate
Dimensions(WxDxH)	Body	mm	1,230 x 380 x 590	1,230 x 380 x 590
		inch	48.4x15x23.2	48.4x15x23.2
Coil	Rows x Columns x FPI		3x13x19	3x13x19
	Face Area	m ² (ft ²)	0.38(4.12)	0.38(4.12)
Fan	Type		Sirocco Fan	Sirocco Fan
	Motor Output x Number	W	185x2	185x2
	Running Current	A	3.5	3.5
	Air Flow Rate(H/M/L) (High Mode-factory set)	cmm	39.1/33.3/29.7	42.2/39.1/33.3
		cfm	1,381/1,176/1,049	1,490/1,381/1,176
	External Static Pressure	mmAq (in.Aq)	14(0.55)	14(0.55)
	Air Flow Rate(H/M/L) (Standard Mode)	cmm	40.5/32.6/31.3	42.4/40.5/32.6
		cfm	1,430/1,151/1,105	1,497/1,430/1,151
	External Static Pressure	mmAq (in.Aq)	10(0.39)	10(0.39)
Drive		Direct	Direct	
Motor type		BLDC	BLDC	
Temperature Control			Microprocessor, Thermostat for cooling and heating	Microprocessor, Thermostat for cooling and heating
Sound Absorbing Thermal Insulation Material			Foamed polystrene	Foamed polystrene
Air Filter			-	-
Safety Device			Fuse	Fuse
Pipe Connections	Liquid Side	mm(inch)	Ø9.52(3/8)	Ø9.52(3/8)
	Gas Side	mm(inch)	Ø15.88(5/8)	Ø15.88(5/8)
	Drain Pipe(Internal Dia.)	mm(inch)	25(1)	25(1)
Net Weight	Body	kg(lbs)	53(116.8)	53(116.8)
Noise Level(Sound Press, 1.5m(4.9ft) H/M/L)		dB(A)±1	42/41/40	43/42/41
Power Supply		Ø, V, Hz	1, 208/230, 60	1, 208/230, 60
Refrigerant Control			EEV	EEV
Power cable		mm ²	CV1.5 x 3C	CV1.5 x 3C
Transmission Cable (AWG#-C)		mm ²	CVV-SB 1.0~1.5 x 2C (12-2)	CVV-SB 1.0~1.5 x 2C (12-2)

Notes:-

1. Capacities are based on the following conditions:

- Cooling
 - Indoor temp. 27°C[80.6°F]DB/ 19°C[66.2°F]WB
 - Outdoor temp. 35°C[95°F]DB/ 24°C[75.2°F]WB
 - Interconnecting Piping Length 7.5m(24.6ft)
 - Level Difference of Zero
- Heating
 - Indoor temp. 20°C[68°F]DB/ 15°C[59°F]WB
 - Outdoor temp. 7°C[44.6°F]DB/ 6°C[42.8°F]WB
 - Interconnecting Piping Length 7.5m(24.6ft)
 - Level Difference of Zero

2. Capacities are net capacities

3. Due to our policy of innovation some specifications may be changed without prior notification

4. To be added for more available Models

5. EEV : Electronic Expansion Valve

6. Noise Level is Standard Mode

(for actual High Mode(factory set) condition, Noise Level may exceed the standard level by 1.5dBA)

Conversion Formula

kcal/h= kW x 860
 Btu/h = kW x 3412
 cfm = m³/min x 35.3
 l/s = CMM x 1000/60

Type			Ceiling Concealed Duct(High Static)	
Model		Unit	ARNU483BRA2	ARNU543BRA2
Cooling Capacity		kW	14.1	15.8
		kcal/h	12,100	13,600
		Btu/h	48,100	54,000
Heating Capacity		kW	15.9	18
		kcal/h	13,200	15,500
		Btu/h	51,200	61,400
Casing			Galvanized Steel Plate	Galvanized Steel Plate
Dimensions(WxDxH)	Body	mm	1230x590x380	1230x380x590
		inch	48.4x23.2x15	48.4x15x23.2
Coil	Rows x Columns x FPI		3x13x19	3x13x19
	Face Area	m ² (ft ²)	0.38	0.38
Fan	Type		Sirocco Fan	Sirocco Fan
	Motor Output x Number	W	185x2	185x2
	Running Current	A	3.5	3.5
	Air Flow Rate(H/M/L)	cmm	44.8/40.6/33.3	51.0/44.8/40.6
	(High Mode-factory set)	cfm	1582/1434/1176	1,800/1,581/1,433
	External Static Pressure	mmAq (in.Aq)	14(140)	14(137)
	Air Flow Rate(H/M/L)	cmm	44.4/39.5/33.5	51.5/47.5/39.5
	(Standard Mode)	cfm	1568/1395/1183	1818/1677/1394
	External Static Pressure	mmAq (in.Aq)	10(100)	10(98)
Drive		Direct	Direct	
Motor type		BLDC	BLDC	
Temperature Control			Microprocessor, Thermostat for cooling and heating	Microprocessor, Thermostat for cooling and heating
Sound Absorbing Thermal Insulation Material			Foamed polystrene	Foamed polystrene
Air Filter			-	-
Safety Device			Fuse	Fuse
Pipe Connections	Liquid Side	mm(inch)	Ø9.52(3/8)	Ø9.52(3/8)
	Gas Side	mm(inch)	Ø15.88(5/8)	Ø15.88(5/8)
	Drain Pipe(Internal Dia.)	mm(inch)	25	32
Net Weight	Body	kg(lbs)	53(117)	53(117)
Noise Level(Sound Press, 1.5m(4.9ft) H/M/L)			dB(A)±1	45/43/41
Power Supply			Ø, V, Hz	1, 220 ~ 240, 50
Refrigerant Control			EEV	EEV
Power cable			mm ²	CV1.5 x 3C
Transmission Cable (AWG#-C)			mm ²	1.0 ~ 1.5 x 2C

Notes:-

1. Capacities are based on the following conditions:

- Cooling
 - Indoor temp. 27°C[80.6°F]DB/ 19°C[66.2°F]WB
 - Outdoor temp. 35°C[95°F]DB/ 24°C[75.2°F]WB
 - Interconnecting Piping Length 7.5m(24.6ft)
 - Level Difference of Zero
- Heating
 - Indoor temp. 20°C[68°F]DB/ 15°C[59°F]WB
 - Outdoor temp. 7°C[44.6°F]DB/ 6°C[42.8°F]WB
 - Interconnecting Piping Length 7.5m(24.6ft)
 - Level Difference of Zero

2. Capacities are net capacities

3. Due to our policy of innovation some specifications may be changed without prior notification

4. To be added for more available Models

5. EEV : Electronic Expansion Valve

6. Noise Level is Standard Mode

(for actual High Mode(factory set) condition, Noise Level may exceed the standard level by 1.5dBA)

Conversion Formula

kcal/h= kW x 860
 Btu/h = kW x 3412
 cfm = m³/min x 35.3
 l/s = CMM x 1000/60

Type			Ceiling Concealed Duct(High Static)		
Model		Unit	ARNU073BGA4	ARNU093BGA4	ARNU123BGA4
Cooling Capacity		kW	2.2	2.8	3.6
		kcal/h	1,900	2,400	3,100
		Btu/h	7,500	9,600	12,300
Heating Capacity		kW	2.5	3.2	4
		kcal/h	2,200	2,800	3,400
		Btu/h	8,500	10,900	13,600
Casing			Galvanized Steel Plate	Galvanized Steel Plate	Galvanized Steel Plate
Dimensions(WxDxH)	Body	mm	1,182 x 298 x 450	1,182 x 298 x 450	1,182 x 298 x 450
		inch	46-17/32 x 11-23/32 x 17-23/32	46-17/32 x 11-23/32 x 17-23/32	46-17/32 x 11-23/32 x 17-23/32
Coil	Rows x Columns x FPI		3 x 12 x 21	3 x 12 x 21	3 x 12 x 21
	Face Area	m ² (ft ²)	0.26(2.82)	0.26(2.82)	0.26(2.82)
Fan	Type		Sirocco Fan	Sirocco Fan	Sirocco Fan
	Motor Output x Number	W	350	350	350
	Running Current	A	2.65	2.65	2.65
	Air Flow Rate(H/M/L) (High Mode-factory set)	cmm	12.5 / 11.5 / 9.4	12.8 / 11.5 / 9.4	13.5 / 12.1 / 9.4
		cfm	441 / 406 / 332	452 / 406 / 332	477 / 427 / 332
	External Static Pressure	mmAq (in.Aq)	6(0.23)	6(0.23)	6(0.23)
	Air Flow Rate(H/M/L) (Standard Mode)	cmm	14.6 / 13.7 / 12.3	15.1 / 13.7 / 12.3	16.6 / 15.1 / 13.7
		cfm	516 / 484 / 434	533 / 484 / 434	586 / 533 / 484
	External Static Pressure	mmAq (in.Aq)	4(0.15)	4(0.15)	4(0.15)
Drive		Direct	Direct	Direct	
Motor type		BLDC	BLDC	BLDC	
Temperature Control			Microprocessor, Thermostat for cooling and heating	Microprocessor, Thermostat for cooling and heating	Microprocessor, Thermostat for cooling and heating
Sound Absorbing Thermal Insulation Material			Foamed polystyrene	Foamed polystyrene	Foamed polystyrene
Air Filter			-	-	-
Safety Device			Fuse	Fuse	Fuse
Pipe Connections	Liquid Side	mm(inch)	Ø9.52(3/8)	Ø9.52(3/8)	Ø9.52(3/8)
	Gas Side	mm(inch)	Ø15.88(5/8)	Ø15.88(5/8)	Ø15.88(5/8)
	Drain Pipe(Internal Dia.)	mm(inch)	25(1)	25(1)	25(1)
Net Weight	Body	kg(lbs)	38(83.8)	38(83.8)	38(83.8)
Noise Level(Sound Press, 1.5m(4.9ft) H/M/L)		dB(A)+1	35 / 35 / 34	35 / 35 / 34	36 / 35 / 34
Power Supply		Ø, V, Hz	1, 208/230, 60	1, 208/230, 60	1, 208/230, 60
Refrigerant Control			EEV	EEV	EEV
Power cable		mm ²	CV1.5 x 3C	CV1.5 x 3C	CV1.5 x 3C
Transmission Cable (AWG#-C)		mm ²	CVV-SB 1.0~1.5 x 2C (12-2)	CVV-SB 1.0~1.5 x 2C (12-2)	CVV-SB 1.0~1.5 x 2C (12-2)

Notes:-

1. Capacities are based on the following conditions:

- Cooling
 - Indoor temp. 27°C[80.6°F]DB/ 19°C[66.2°F]WB
 - Outdoor temp. 35°C[95°F]DB/ 24°C[75.2°F]WB
 - Interconnecting Piping Length 7.5m(24.6ft)
 - Level Difference of Zero
- Heating
 - Indoor temp. 20°C[68°F]DB/ 15°C[59°F]WB
 - Outdoor temp. 7°C[44.6°F]DB/ 6°C[42.8°F]WB
 - Interconnecting Piping Length 7.5m(24.6ft)
 - Level Difference of Zero

2. Capacities are net capacities

3. Due to our policy of innovation some specifications may be changed without prior notification

4. To be added for more available Models

5. EEV : Electronic Expansion Valve

6. Noise Level is Standard Mode

(for actual High Mode(factory set) condition, Noise Level may exceed the standard level by 1.5dBA)

Conversion Formula

kcal/h= kW x 860
 Btu/h = kW x 3412
 cfm = m³/min x 35.3
 l/s = CMM x 1000/60

Type		Ceiling Concealed Duct(High Static)			
Model	Unit	ARNU153BGA4	ARNU183BGA4	ARNU243BGA4	
Cooling Capacity	kW	4.5	5.6	7.1	
	kcal/h	3,900	4,800	6,100	
	Btu/h	15,400	19,100	24,200	
Heating Capacity	kW	5.0	6.3	8.0	
	kcal/h	4,300	5,400	6,900	
	Btu/h	17,100	21,500	27,300	
Casing		Galvanized Steel Plate	Galvanized Steel Plate	Galvanized Steel Plate	
Dimensions(WxDxH)	Body	mm	1,182 x 298 x 450	1,182 x 298 x 450	
		inch	46-17/32 x 11-23/32 x 17-23/32	46-17/32 x 11-23/32 x 17-23/32	
Coil	Rows x Columns x FPI		3 x 12 x 21	3 x 12 x 21	
	Face Area	m ² (ft ²)	0.26(2.82)	0.26(2.82)	
Fan	Type		Sirocco Fan	Sirocco Fan	
	Motor Output x Number	W	350	350	
	Running Current	A	2.65	2.65	
	Air Flow Rate(H/M/L) (High Mode-factory set)	cmm	13.8 / 11.8 / 8.3	15.2 / 13.8 / 11.8	19.0 / 15.2 / 13.8
		cfm	487 / 417 / 293	537 / 487 / 417	671 / 537 / 487
	External Static Pressure	mmAq (in.Aq)	8(0.31)	8(0.31)	8(0.31)
	Air Flow Rate(H/M/L) (Standard Mode)	cmm	13.5 / 12.1 / 9.0	15.5 / 13.3 / 12.1	19.0 / 16.3 / 15.5
		cfm	477 / 427 / 318	547 / 470 / 427	671 / 576 / 547
	External Static Pressure	mmAq (in.Aq)	6(0.23)	6(0.23)	6(0.23)
Drive		Direct	Direct	Direct	
Motor type		BLDC	BLDC	BLDC	
Temperature Control			Microprocessor, Thermostat for cooling and heating	Microprocessor, Thermostat for cooling and heating	
Sound Absorbing Thermal Insulation Material			Foamed polystyrene	Foamed polystyrene	
Air Filter			-	-	
Safety Device			Fuse	Fuse	
Pipe Connections	Liquid Side	mm(inch)	Ø9.52(3/8)	Ø9.52(3/8)	
	Gas Side	mm(inch)	Ø15.88(5/8)	Ø15.88(5/8)	
	Drain Pipe(Internal Dia.)	mm(inch)	25(1)	25(1)	
Net Weight	Body	kg(lbs)	38(83.8)	38(83.8)	
Noise Level(Sound Press, 1.5m(4.9ft) H/M/L)		dB(A)+1	35 / 35 / 34	36 / 35 / 34	
Power Supply		Ø, V, Hz	1, 208/230, 60	1, 208/230, 60	
Refrigerant Control			EEV	EEV	
Power cable		mm ²	CV1.5 x 3C	CV1.5 x 3C	
Transmission Cable (AWG#-C)		mm ²	CVV-SB 1.0~1.5 x 2C (12-2)	CVV-SB 1.0~1.5 x 2C (12-2)	

Notes:-

1. Capacities are based on the following conditions:

- Cooling
 - Indoor temp. 27°C[80.6°F]DB/ 19°C[66.2°F]WB
 - Outdoor temp. 35°C[95°F]DB/ 24°C[75.2°F]WB
 - Interconnecting Piping Length 7.5m(24.6ft)
 - Level Difference of Zero
- Heating
 - Indoor temp. 20°C[68°F]DB/ 15°C[59°F]WB
 - Outdoor temp. 7°C[44.6°F]DB/ 6°C[42.8°F]WB
 - Interconnecting Piping Length 7.5m(24.6ft)
 - Level Difference of Zero

2. Capacities are net capacities

3. Due to our policy of innovation some specifications may be changed without prior notification

4. To be added for more available Models

5. EEV : Electronic Expansion Valve

6. Noise Level is Standard Mode

(for actual High Mode(factory set) condition, Noise Level may exceed the standard level by 1.5dBA)

Conversion Formula

kcal/h= kW x 860
 Btu/h = kW x 3412
 cfm = m³/min x 35.3
 l/s = CMM x 1000/60

Type			Ceiling Concealed Duct(High Static)			
Model		Unit	ARNU283BGA4	ARNU363BGA4	ARNU423BGA4	
Cooling Capacity		kW	8.2	10.6	12.3	
		kcal/h	7,100	9,100	10,600	
		Btu/h	28,000	36,200	42,000	
Heating Capacity		kW	9.2	11.9	13.8	
		kcal/h	8,000	10,200	11,000	
		Btu/h	31,500	40,600	43,800	
Casing			Galvanized Steel Plate	Galvanized Steel Plate	Galvanized Steel Plate	
Dimensions(WxDxH)	Body	mm	1,182 x 298 x 450	1,182 x 298 x 450	1,182 x 298 x 450	
		inch	46-17/32 x 11-23/32 x 17-23/32	46-17/32 x 11-23/32 x 17-23/32	46-17/32 x 11-23/32 x 17-23/32	
Coil	Rows x Columns x FPI		3 x 12 x 21	3 x 12 x 21	3 x 12 x 21	
	Face Area		m ² (ft ²)	0.26(2.82)	0.26(2.82)	0.26(2.82)
Fan	Type		Sirocco Fan	Sirocco Fan	Sirocco Fan	
	Motor Output x Number		W	350	350	350
	Running Current		A	2.65	2.65	2.65
	Air Flow Rate(H/M/L) (High Mode-factory set)		cmm	25.9 / 24.1 / 21.8	32.3 / 29.0 / 25.3	34.5 / 32.3 / 30.7
			cfm	915 / 851 / 770	1,141 / 1,024 / 894	1,218 / 1,141 / 1,084
	External Static Pressure		mmAq (in.Aq)	10(0.39)	10(0.39)	10(0.39)
	Air Flow Rate(H/M/L) (Standard Mode)		cmm	25.3 / 21.8 / 17.6	28.4 / 25.3 / 21.8	32.0 / 28.4 / 27.2
			cfm	893 / 770 / 622	1,003 / 894 / 770	1,130 / 1,003 / 961
	External Static Pressure		mmAq (in.Aq)	8(0.31)	8(0.31)	8(0.31)
Drive			Direct	Direct	Direct	
Motor type			BLDC	BLDC	BLDC	
Temperature Control			Microprocessor, Thermostat for cooling and heating	Microprocessor, Thermostat for cooling and heating	Microprocessor, Thermostat for cooling and heating	
Sound Absorbing Thermal Insulation Material			Foamed polystyrene	Foamed polystyrene	Foamed polystyrene	
Air Filter			-	-	-	
Safety Device			Fuse	Fuse	Fuse	
Pipe Connections	Liquid Side	mm(inch)	Ø9.52(3/8)	Ø9.52(3/8)	Ø9.52(3/8)	
	Gas Side	mm(inch)	Ø15.88(5/8)	Ø15.88(5/8)	Ø15.88(5/8)	
	Drain Pipe(Internal Dia.)	mm(inch)	25(1)	25(1)	25(1)	
Net Weight	Body	kg(lbs)	38(83.8)	38(83.8)	38(83.8)	
Noise Level(Sound Press, 1.5m(4.9ft) H/M/L)		dB(A)+1	36 / 35 / 34	36 / 35 / 34	36 / 35 / 34	
Power Supply		Ø, V, Hz	1, 208/230, 60	1, 208/230, 60	1, 208/230, 60	
Refrigerant Control			EEV	EEV	EEV	
Power cable		mm ²	CV1.5 x 3C	CV1.5 x 3C	CV1.5 x 3C	
Transmission Cable (AWG#-C)		mm ²	CVV-SB 1.0~1.5 x 2C (12-2)	CVV-SB 1.0~1.5 x 2C (12-2)	CVV-SB 1.0~1.5 x 2C (12-2)	

Notes:-

1. Capacities are based on the following conditions:

- Cooling
 - Indoor temp. 27°C[80.6°F]DB/ 19°C[66.2°F]WB
 - Outdoor temp. 35°C[95°F]DB/ 24°C[75.2°F]WB
 - Interconnecting Piping Length 7.5m(24.6ft)
 - Level Difference of Zero
- Heating
 - Indoor temp. 20°C[68°F]DB/ 15°C[59°F]WB
 - Outdoor temp. 7°C[44.6°F]DB/ 6°C[42.8°F]WB
 - Interconnecting Piping Length 7.5m(24.6ft)
 - Level Difference of Zero

2. Capacities are net capacities

3. Due to our policy of innovation some specifications may be changed without prior notification

4. To be added for more available Models

5. EEV : Electronic Expansion Valve

6. Noise Level is Standard Mode

(for actual High Mode(factory set) condition, Noise Level may exceed the standard level by 1.5dBA)

Conversion Formula

kcal/h= kW x 860
 Btu/h = kW x 3412
 cfm = m³/min x 35.3
 l/s = CMM x 1000/60

Type			Ceiling Concealed Duct(High Static)	
Model		Unit	ARNU483BRA4	ARNU543BRA4
Cooling Capacity		kW	14.1	15.8
		kcal/h	12,100	13,600
		Btu/h	48,100	54,000
Heating Capacity		kW	15.9	18.0
		kcal/h	13,200	15,500
		Btu/h	51,200	61,400
Casing			Galvanized Steel Plate	Galvanized Steel Plate
Dimensions(WxDxH)	Body	mm	1,230 x 380 x 590	1,230 x 380 x 590
		inch	48-7/16 x 14-31/32 x 23-7/32	48-7/16 x 14-31/32 x 23-7/32
Coil	Rows x Columns x FPI		3 x 13 x 19	3 x 13 x 19
	Face Area	m ² (ft ²)	0.38(4.12)	0.38(4.12)
Fan	Type		Sirocco Fan	Sirocco Fan
	Motor Output x Number	W	185 x 2	185 x 2
	Running Current	A	3.5	3.5
	Air Flow Rate(H/M/L) (High Mode-factory set)	cmm	44.8 / 40.6 / 33.3	51.0 / 44.8 / 40.6
		cfm	1,582 / 1,434 / 1,176	1,801 / 1,582 / 1,434
	External Static Pressure	mmAq (in.Aq)	14(0.55)	14(0.55)
	Air Flow Rate(H/M/L) (Standard Mode)	cmm	44.4 / 39.5 / 33.5	51.5 / 47.5 / 39.5
		cfm	1,568 / 1,395 / 1,183	1,819 / 1,678 / 1,395
	External Static Pressure	mmAq (in.Aq)	10(0.39)	10(0.39)
Drive		Direct	Direct	
Motor type		BLDC	BLDC	
Temperature Control			Microprocessor, Thermostat for cooling and heating	Microprocessor, Thermostat for cooling and heating
Sound Absorbing Thermal Insulation Material			Foamed polystrene	Foamed polystrene
Air Filter			-	-
Safety Device			Fuse	Fuse
Pipe Connections	Liquid Side	mm(inch)	Ø9.52(3/8)	Ø9.52(3/8)
	Gas Side	mm(inch)	Ø15.88(5/8)	Ø15.88(5/8)
	Drain Pipe(Internal Dia.)	mm(inch)	25(1)	25(1)
Net Weight	Body	kg(lbs)	53(117)	53(117)
Noise Level(Sound Press, 1.5m(4.9ft) H/M/L)		dB(A)+1	45 / 43 / 41	46 / 45 / 43
Power Supply		Ø, V, Hz	1, 208/230, 60	1, 208/230, 60
Refrigerant Control			EEV	EEV
Power cable		mm ²	CV1.5 x 3C	CV1.5 x 3C
Transmission Cable (AWG#-C)		mm ²	CVV-SB 1.0~1.5 x 2C (12-2)	CVV-SB 1.0~1.5 x 2C (12-2)

Notes:-

1. Capacities are based on the following conditions:

- Cooling
 - Indoor temp. 27°C[80.6°F]DB/ 19°C[66.2°F]WB
 - Outdoor temp. 35°C[95°F]DB/ 24°C[75.2°F]WB
 - Interconnecting Piping Length 7.5m(24.6ft)
 - Level Difference of Zero
- Heating
 - Indoor temp. 20°C[68°F]DB/ 15°C[59°F]WB
 - Outdoor temp. 7°C[44.6°F]DB/ 6°C[42.8°F]WB
 - Interconnecting Piping Length 7.5m(24.6ft)
 - Level Difference of Zero

2. Capacities are net capacities

3. Due to our policy of innovation some specifications may be changed without prior notification

4. To be added for more available Models

5. EEV : Electronic Expansion Valve

6. Noise Level is Standard Mode

(for actual High Mode(factory set) condition, Noise Level may exceed the standard level by 1.5dBA)

Conversion Formula

kcal/h= kW x 860
 Btu/h = kW x 3412
 cfm = m³/min x 35.3
 l/s = CMM x 1000/60

2. List of Functions

Category	Function	ARNU073BHA2	ARNU153BGA2	ARNU093BGA2	ARNU093BGA4	ARNU423BGA4
		ARNU093BHA2	ARNU183BGA2	ARNU123BGA2	ARNU123BGA4	ARNU483BRA4
		ARNU123BHA2	ARNU243BGA2	ARNU283BRA2	ARNU153BGA4	ARNU543BRA4
		ARNU153BHA2	ARNU363BGA2	ARNU363BRA2	ARNU183BGA4	
		ARNU183BHA2	ARNU423BGA2	ARNU423BRA2	ARNU243BGA4	
		ARNU243BHA2	ARNU483BRA2	ARNU543BRA2	ARNU283BGA4	
		ARNU283BGA2	ARNU073BGA2	ARNU073BGA4	ARNU363BGA4	
Air flow	Air supply outlet				1	
	Airflow direction control(left & right)				-	
	Airflow direction control(up & down)				-	
	Auto swing(left & right)				-	
	Auto swing(up & down)				-	
	Airflow steps(fan/cool/heat)				3/3/3	
	Chaos swing				-	
	Chaos wind(auto wind)				-	
	Jet cool(Power wind)				-	
	Swirl wind				-	
Air purifying	Deodorizing filter				X	
	Plasma air purifier				X	
	Prefilter(washable / anti-fungus)				O	
Installation	Drain pump				O	
	E.S.P. control				O	
	Electric heater(operation)				X	
	High ceiling operation				-	
Reliability	Hot start				O	
	Self diagnosis				O	
	Soft dry operation				O	
Convenience	Auto changeover				O(only heat recovery)	
	Auto cleaning				X	
	Auto operation(artificial intelligence)				O(only heat pump or cooling only)	
	Auto restart operation				O	
	Child lock				O	
	Forced operation				-	
	Group control				O	
	Sleep mode				X	
	Timer(on/off)				O	
	Timer(weekly)				O	
Two thermistor control				O		
Individual control	Standard wired remote controller				Accessory	
	Wide Character wired remote controller				Accessory	
	Picto wired remote controller				Accessory	
	Deluxe wired remote controller				Accessory	
	Simple wired remote controller				Accessory	
	Wired remote controller(for hotel use)				Accessory	
	Wireless remote controller(simple)				X	
	Wireless LCD remote control				Accessory	
Special function kit	Zone control				Accessory	
	CTIE				-	
	Electro thermostat				-	

O : Applied X : Not applied - : No relation

Option : Model name & price are different according to options, and assembled in factory with main unit.

Accessory : Installed at field, ordered and purchased separately by the corresponding model name, supplied with separate package.

3. Piping Diagrams

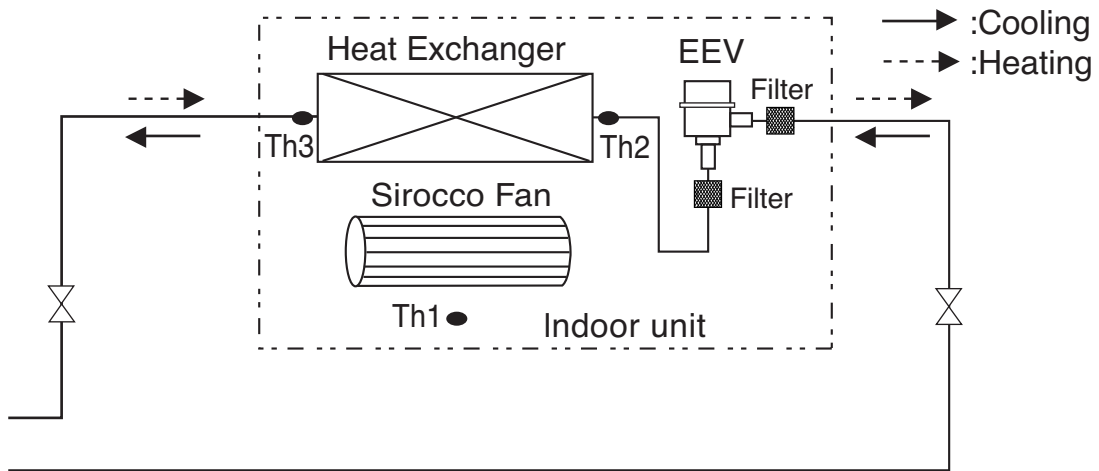

Refrigerant pipe connection port diameter

[unit: mm(inch)]

MODEL	GAS	LIQUID
ARNU073BHA2	Ø12.7(1/2)	Ø6.35(1/4)
ARNU093BHA2	Ø12.7(1/2)	Ø6.35(1/4)
ARNU123BHA2	Ø12.7(1/2)	Ø6.35(1/4)
ARNU153BHA2	Ø12.7(1/2)	Ø6.35(1/4)
ARNU183BHA2	Ø12.7(1/2)	Ø6.35(1/4)
ARNU243BHA2	Ø15.88(5/8)	Ø9.52(3/8)
ARNU073BGA2	Ø15.88(5/8)	Ø9.52(3/8)
ARNU093BGA2	Ø15.88(5/8)	Ø9.52(3/8)
ARNU123BGA2	Ø15.88(5/8)	Ø9.52(3/8)
ARNU153BGA2	Ø15.88(5/8)	Ø9.52(3/8)
ARNU183BGA2	Ø15.88(5/8)	Ø9.52(3/8)
ARNU243BGA2	Ø15.88(5/8)	Ø9.52(3/8)
ARNU283BGA2	Ø15.88(5/8)	Ø9.52(3/8)
ARNU363BGA2	Ø15.88(5/8)	Ø9.52(3/8)
ARNU423BGA2	Ø15.88(5/8)	Ø9.52(3/8)
ARNU283BRA2	Ø15.88(5/8)	Ø9.52(3/8)
ARNU363BRA2	Ø15.88(5/8)	Ø9.52(3/8)
ARNU423BRA2	Ø15.88(5/8)	Ø9.52(3/8)
ARNU483BRA2	Ø15.88(5/8)	Ø9.52(3/8)
ARNU543BRA2	Ø15.88(5/8)	Ø9.52(3/8)
ARNU073BGA4	Ø15.88(5/8)	Ø9.52(3/8)
ARNU093BGA4	Ø15.88(5/8)	Ø9.52(3/8)
ARNU123BGA4	Ø15.88(5/8)	Ø9.52(3/8)
ARNU153BGA4	Ø15.88(5/8)	Ø9.52(3/8)
ARNU183BGA4	Ø15.88(5/8)	Ø9.52(3/8)
ARNU243BGA4	Ø15.88(5/8)	Ø9.52(3/8)
ARNU283BGA4	Ø15.88(5/8)	Ø9.52(3/8)
ARNU363BGA4	Ø15.88(5/8)	Ø9.52(3/8)
ARNU423BGA4	Ø15.88(5/8)	Ø9.52(3/8)
ARNU483BRA4	Ø15.88(5/8)	Ø9.52(3/8)
ARNU543BRA4	Ø15.88(5/8)	Ø9.52(3/8)

LOC.	Description
Th1	Room thermistor
Th2	Pipe in thermistor
Th3	Pipe out thermistor

4. Wiring Diagrams

BH Chassis

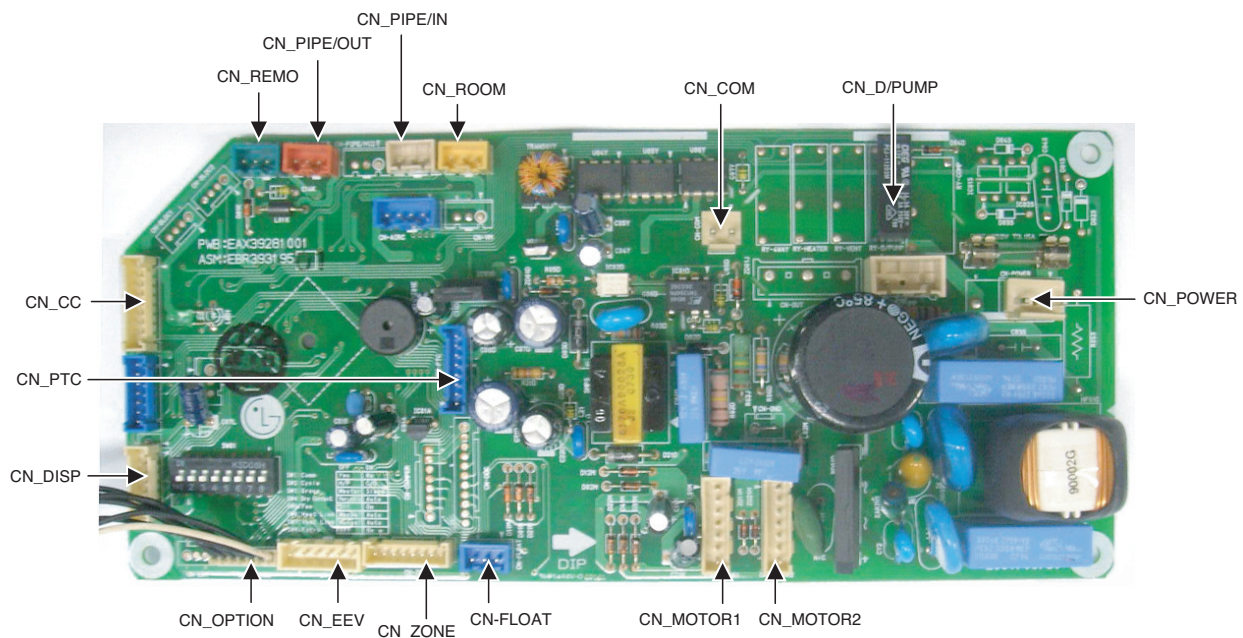
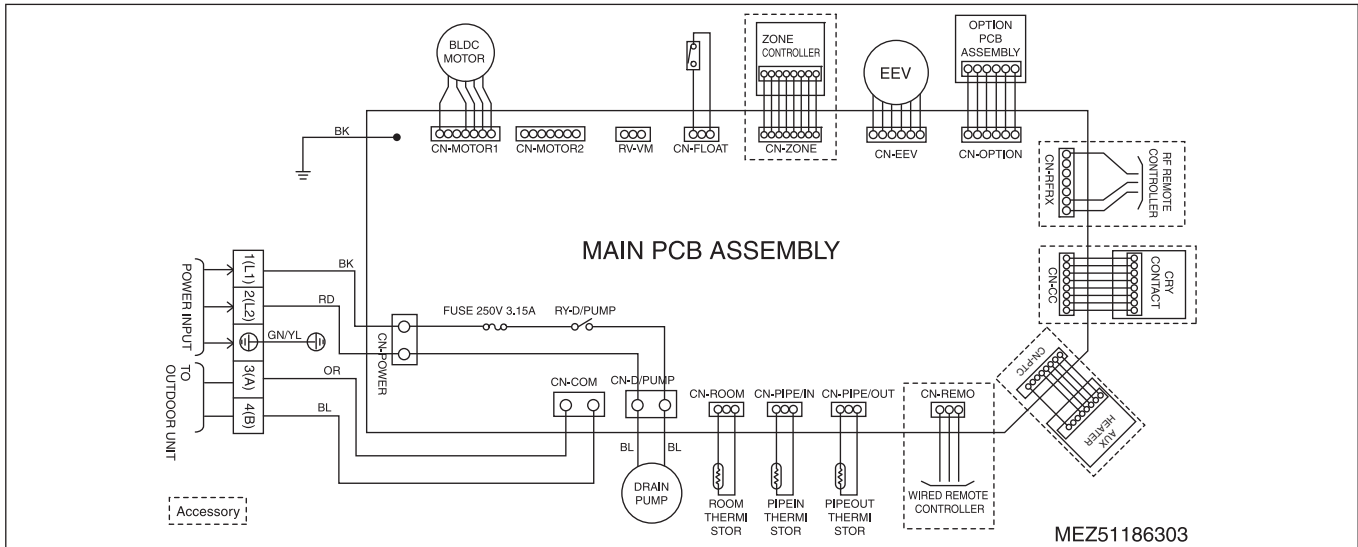

Dip Switch Setting		ON	OFF	Remarks
SW3	GROUP	Master	Slave	Group Control setting using Wired Remote Controller
SW4	DRY CONTACT	Variable	Auto	Dry contact mode setting
SW5	EXTRA 1	OFF	ON	1. Duct model - OFF : Default(not operate continuously) - ON : Fan operate continuously 2. Cassette Model : No Function 3. Ceiling Suspended Model - OFF : Ceiling(default) - ON : Floor

⚠ CAUTION

For Multi V Model, Dip Switch 1,2,5,6,7,8 must be set OFF
That dip switch is used for the other model.

BG Chassis

ARNU073BGA4

ARNU153BGA4

ARNU283BGA4

ARNU483BRA4

ARNU093BGA4

ARNU183BGA4

ARNU363BGA4

ARNU543BRA4

ARNU123BGA4

ARNU243BGA4

ARNU423BGA4

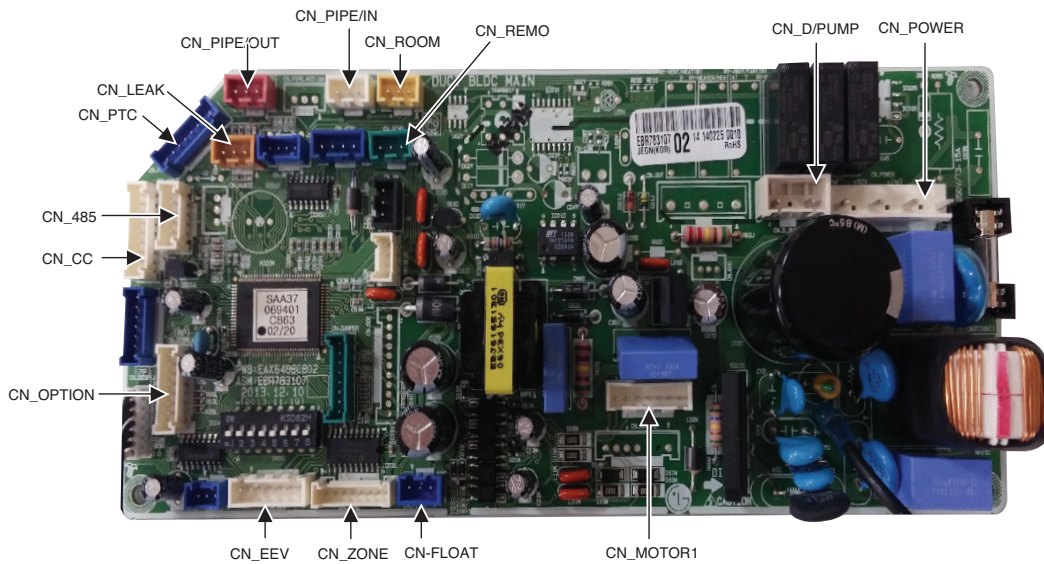
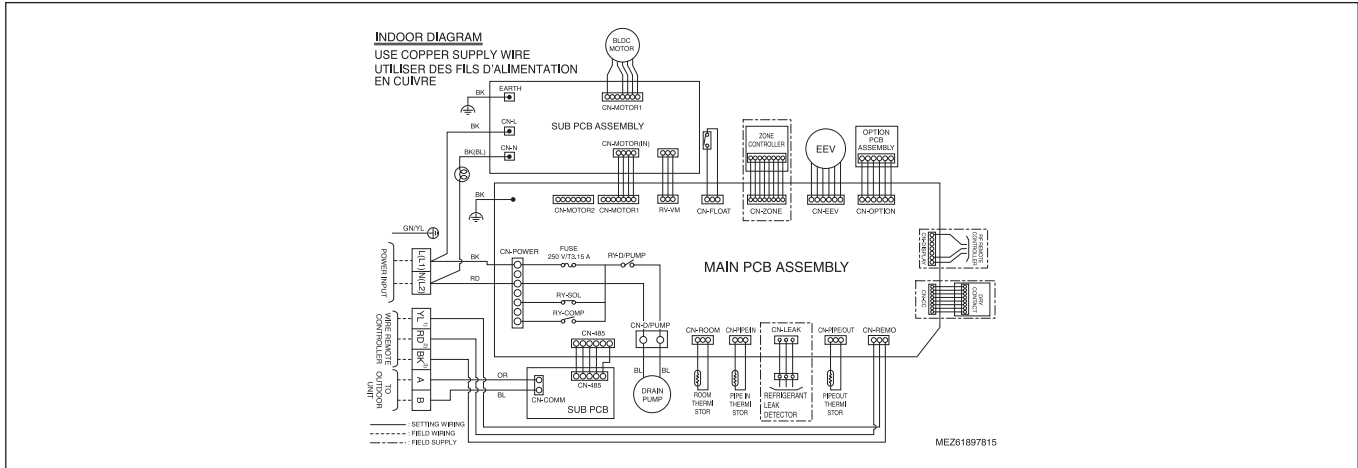

Dip Switch Setting		ON	OFF	Remarks
SW3	GROUP	Master	Slave	Group Control setting using Wired Remote Controller
SW4	DRY CONTACT	Variable	Auto	Dry contact mode setting
SW5	EXTRA 1	OFF	ON	1. Duct model - OFF : Default(not operate continuously) - ON : Fan operate continuously 2. Cassette Model : No Function 3. Ceiling Suspended Model - OFF : Ceiling(default) - ON : Floor

CAUTION

For Multi V Model, Dip Switch 1,2,5,6,7,8 must be set OFF
 That dip switch is used for the other model.

BR Chassis

ARNU283BRA2 ARNU363BRA2 ARNU423BRA2 ARNU483BRA2 ARNU543BRA2

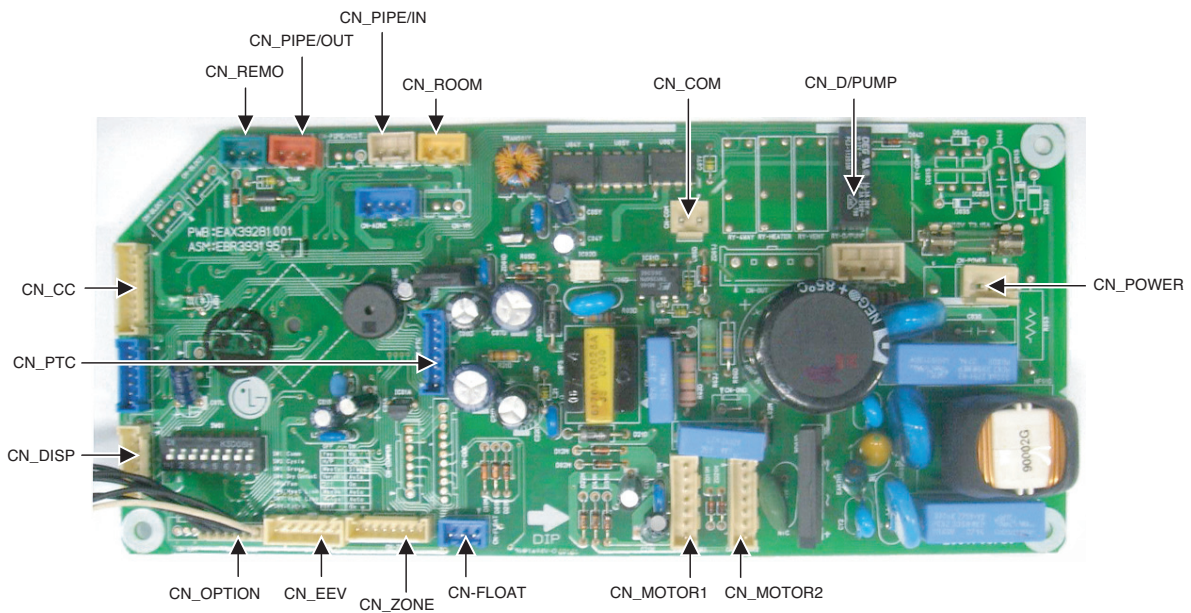
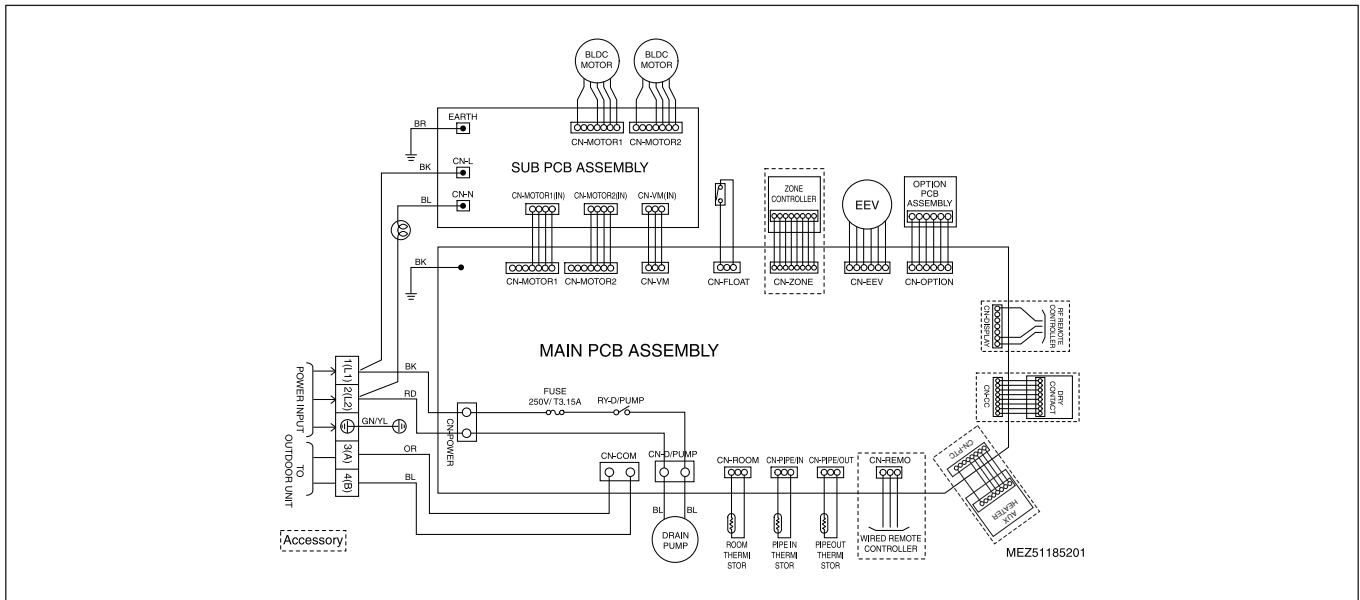

Dip Switch Setting		ON	OFF	Remarks
SW3	GROUP	Master	Slave	Group Control setting using Wired Remote Controller
SW4	DRY CONTACT	Variable	Auto	Dry contact mode setting
SW5	EXTRA 1	OFF	ON	1. Duct model - OFF : Default(not operate continuously) - ON : Fan operate continuously 2. Cassette Model : No Function 3. Ceiling Suspended Model - OFF : Ceiling(default) - ON : Floor

⚠ CAUTION

For Multi V Model, Dip Switch 1,2,5,6,7,8 must be set OFF
That dip switch is used for the other model.

BR Chassis

ARNU483BRA4 ARNU543BRA4

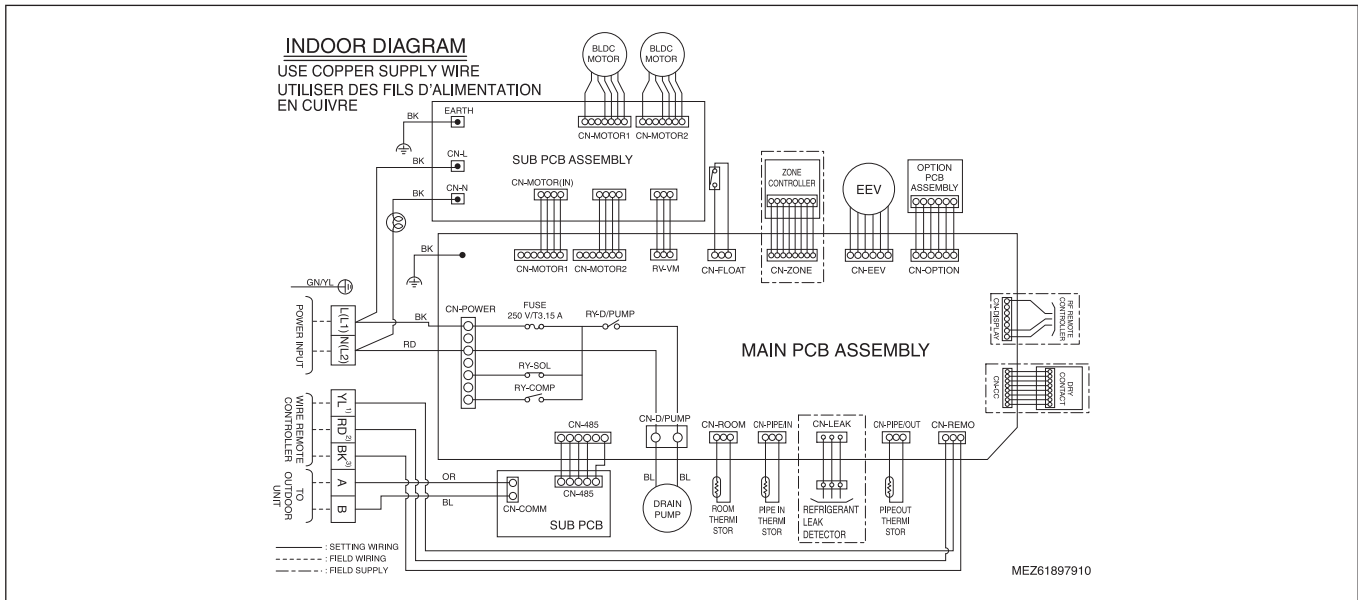

Dip Switch Setting		ON	OFF	Remarks
SW3	GROUP	Master	Slave	Group Control setting using Wired Remote Controller
SW4	DRY CONTACT	Variable	Auto	Dry contact mode setting
SW5	EXTRA 1	OFF	ON	1. Duct model - OFF : Default(not operate continuously) - ON : Fan operate continuously 2. Cassette Model : No Function 3. Ceiling Suspended Model - OFF : Ceiling(default) - ON : Floor

⚠ CAUTION

**For Multi V Model, Dip Switch 1,2,5,6,7,8 must be set OFF
That dip switch is used for the other model.**

BG

ARNU073BGA2 ARNU123BGA2 ARNU183BGA2 ARNU283BGA2 ARNU423BGA2
ARNU093BGA2 ARNU153BGA2 ARNU243BGA2 ARNU363BGA2

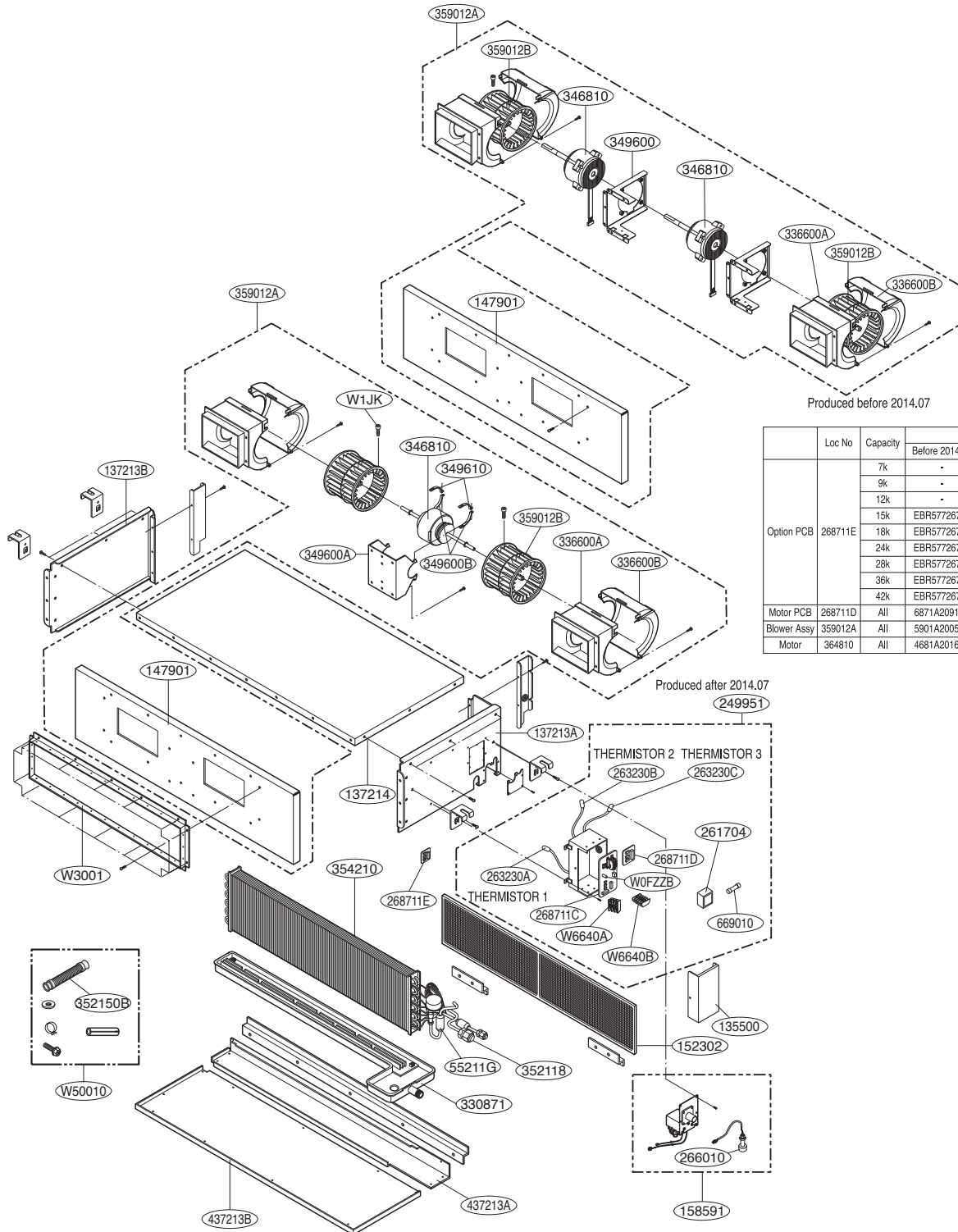

Loc No	Capacity	P/No	
		Before 2014.07	After 2014.07
Option PCB	7k	-	EBR72936314
	9k	-	EBR72936315
	12k	-	EBR72936317
	15k	EBR57726720	EBR72936318
	18k	EBR57726721	EBR72936319
	24k	EBR57726722	EBR72936320
	28k	EBR57726707	EBR72936310
	36k	EBR57726708	EBR72936311
Motor PCB	42k	EBR57726709	EBR72936312
	All	6871A20912A	EBR72059601
Blower Assy	359012A	All	5901A20053A ADP73683501
Motor	346810	All	4681A20169B EAU37067106

Thermistor 1	263230A	Air	Housing color : yellow
Thermistor 2	263230B	Eva. in	Housing color : white
Thermistor 3	263230C	Eva. out	Housing color : red

BR

ARNU283BRA2 ARNU363BRA2 ARNU423BRA2 ARNU483BRA2 ARNU543BRA2

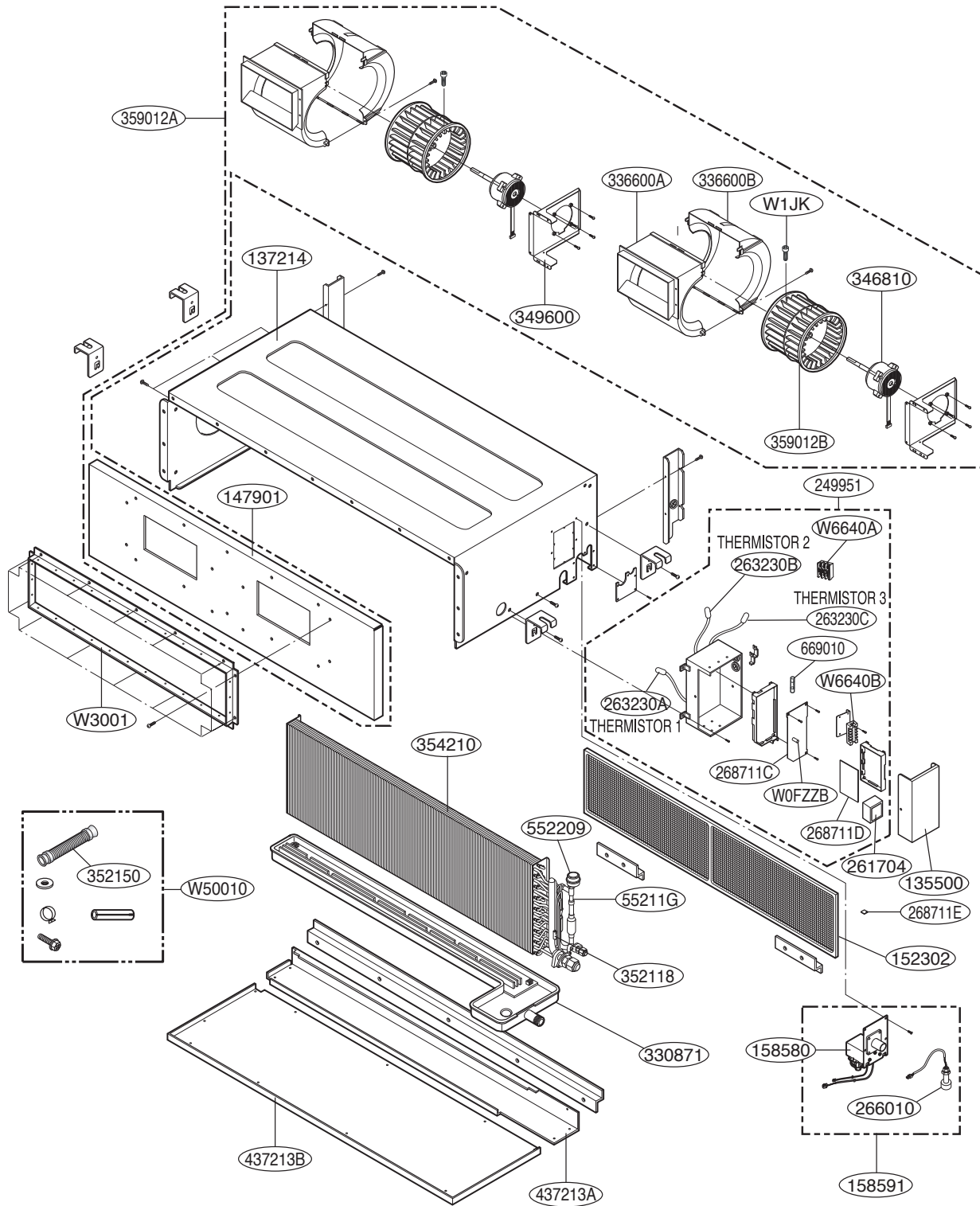

Thermistor 1	263230A	Air	Housing color : yellow
Thermistor 2	263230B	Eva. in	Housing color : white
Thermistor 3	263230C	Eva. out	Housing color : red

BG

ARNU073BGA4 ARNU123BGA4 ARNU183BGA4 ARNU283BGA4 ARNU423BGA4
 ARNU093BGA4 ARNU153BGA4 ARNU243BGA4 ARNU363BGA4

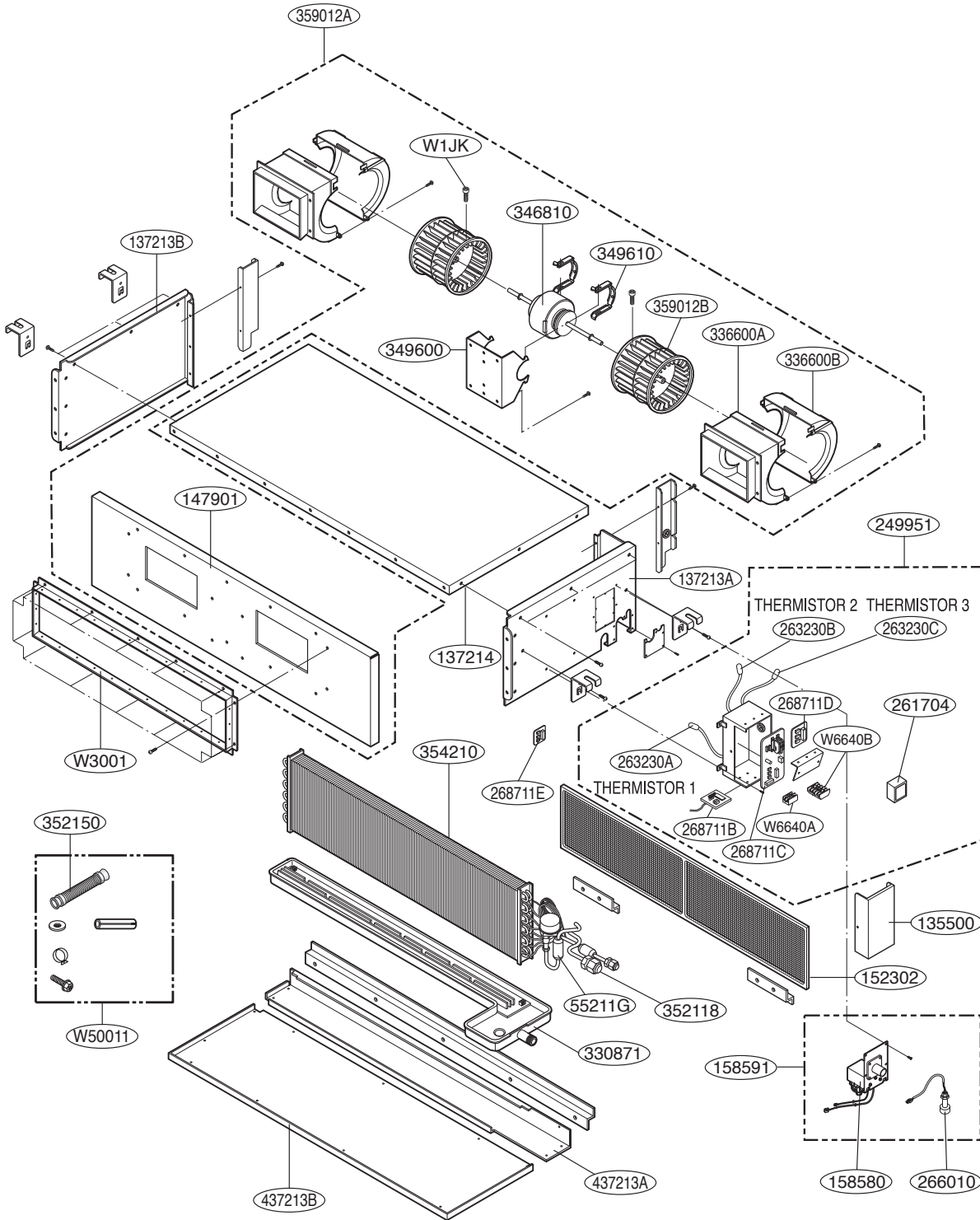

Thermistor 1	263230A	Air	Housing color : yellow
Thermistor 2	263230B	Eva. in	Housing color : white
Thermistor 3	263230C	Eva. out	Housing color : red

BR

ARNU483BRA4 ARNU543BRA4

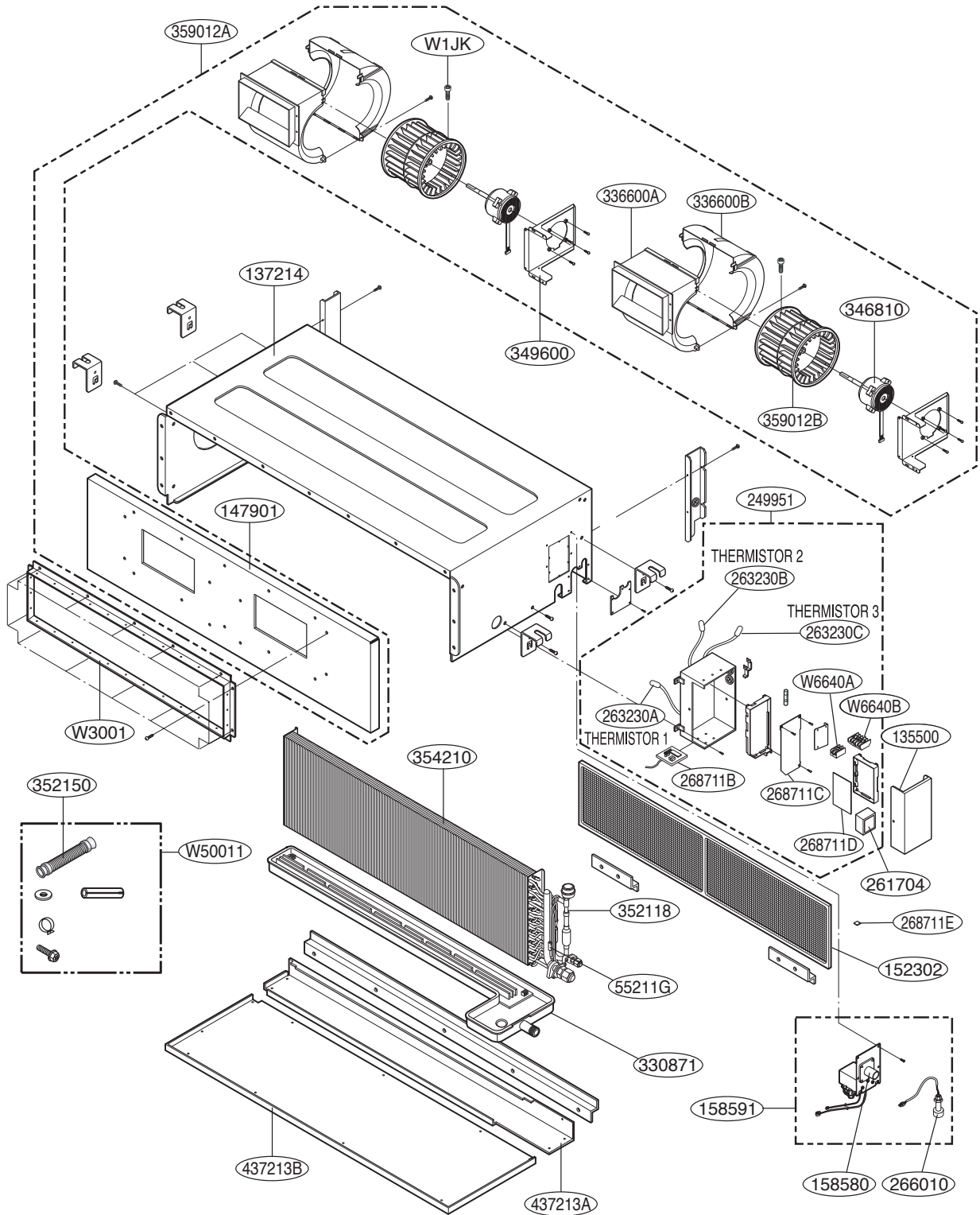

Thermistor 1	263230A	Air	Housing color : yellow
Thermistor 2	263230B	Eva. in	Housing color : white
Thermistor 3	263230C	Eva. out	Housing color : red



P/NO : MFL42947615